

ORDINANCE NO. 5158

AN ORDINANCE relating to the King County Capital Budget and Program appropriating \$174,750 from an Interagency Committee for Outdoor Recreation Grant Award to the Park Acquisition and Development Fund for the Maple Valley to Lake Wilderness Trail Capital Improvement Project, increasing the 1980 Capital Improvement Budget and amending Ordinance No. 4597, Section 74, as amended, and Section 73, Attachment No. 1, as amended.

BE IT ORDAINED BY THE COUNCIL OF KING COUNTY:

SECTION 1. There is hereby approved and adopted an appropriation in the amount of \$174,750 to the Park Acquisition and Development Fund from a contracted I.A.C. Grant Award for the acquisition of the Maple Valley to Lake Wilderness Trail Project.

SECTION 2. Ordinance No. 4597, Section 74, as amended, is hereby amended to read as follows:

Park Acquisition and Development ~~{{(\$3,623,936}}~~ \$3,798,686

SECTION 3. Ordinance No. 4597, Section 73, Attachment No. 1, as amended, is hereby revised as shown on the attached Capital Budget Resource page.

INTRODUCED AND READ for the first time this 13<sup>th</sup> day of October, 1980.

PASSED this 20<sup>th</sup> day of October, 1980.

KING COUNTY COUNCIL  
KING COUNTY, WASHINGTON

Bill Reams  
Chairman

ATTEST:

Juanita M. Owens DEPUTY  
Clerk of the Council

APPROVED this 24<sup>th</sup> day of October, 1980.

Robert W. Gault  
King County Executive

Project: 007244 Maple Valley to Lake Wilderness Trail

Description:

Council District: No. 9  
CIP Planning Area: S.E. Central

This trail includes approximately three and one-half miles of abandoned railroad right-of-way between Maple Valley and the N.E. shore of Lake Wilderness. It encompasses nearly 30 acres.

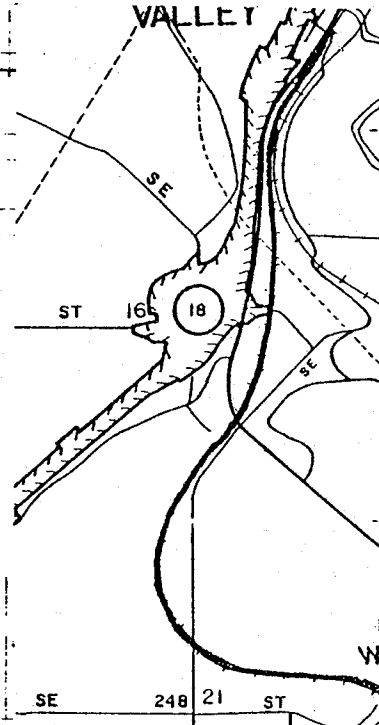

**Project Comparison**  
1979-1984 vs. 1980-1985

- No Changes  
 New  
 To Be Abandoned  
 Revenue Change  
 To Be Merged  
 Scope Change  
 Total Cost Change  
 Schedule Change  
 Site Change

**Cost Data:**

Original Cost Estimate (1977) \$110,000  
Total Cost Estimate (1977) \$289,000

**Status:**

Acquisition is underway for the funded portion.

**Project Data:**

FUND	000003370	PARK ACQUISITION & DVLPMNT	DEPARTMENT PRIORITY REQUEST 000
DEPARTMENT	0344	PARKS-337/ACQUIST & DEV	LOCATION - RR LINE MAPLE VALLEY-L.WILDER
FUNCTION	53300	PARKS & RECREATION	CURRENT PROJECT COST ESTIMATE
SERVICE	53350	PARKS CIP	EXPENDED & APPROPRIATED (INC RECOMMENDED)
PROGRAM	53359	TRAILS	FUTURE FUNDING REQUIRED TO COMPLETE PROJECT

OPTION	EXPENDITURES TO 12-31-78 (A)	EXISTING BUDGET (B)	1980 RECOMMENDED (C)	EXP + BUDGET + RECOMMENDED (A+B+C)	*PROGRAM PROJECTIONS - THOUSANDS OF
					1981 1982 1983 1984 1985
--- EXPENDITURE DATA ---					
ACQUISIT RIGHT/WAY	4,229	105,770	174,750	284,749	* * *
EXPENDITURE TOTALS	4,229	105,770	174,750	284,749	* * *
--- REVENUE SOURCES ---					
33431 (A) IAC Grant			174,750	174,750	* * *
37246 (A) CONTRBTN-COMM. DIV. BLOCK		105,770		105,770	* * *
PRICR YRS REV	4,229			4,229	* * *
REVENUE TOTALS	4,229	105,770	175,750	184,749	* * *
REVENUE AVAILABLE	284,749				
		REVENUE PENDING	0		